

2. SPRAT

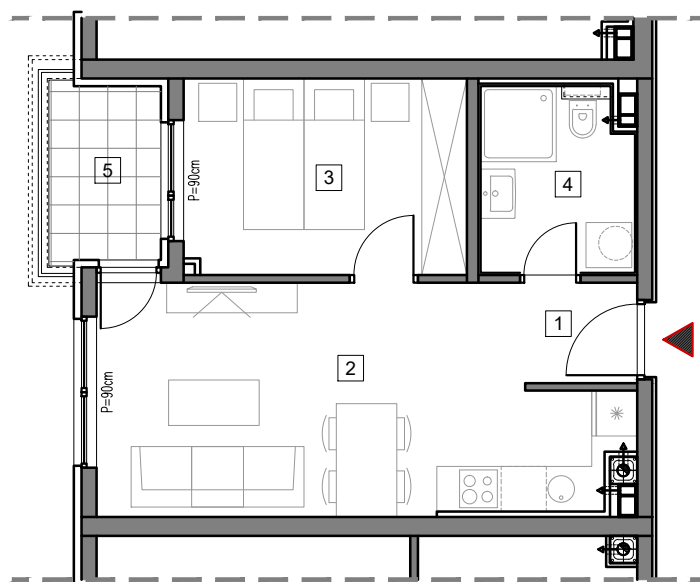

STAMBENO-POSLOVNI OBJEKAT "DOBRINJA"

STAN A203

1	HOL	2.0m ²
2	DNEVNA SOBA, KUHINJA I TRPEZARIJA	19.2m ²
3	SOBA	9.5m ²
4	KUPATILO	4.9m ²
5	LOĐA (75%)	2.6m ²

UKUPNO 38.2m²



BUTMIR